

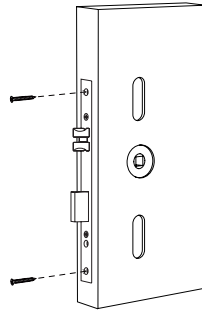

Schlage **S-710** INSTALLATION MANUAL

1. PREPARE THE DOOR

Prepare the door as per the Schlage S-710 Digital Door Lock Door Preparation template.



2. FASTEN POSTS

Attach the post to the lower stud on the back of the external unit.

Attach the second post to the fixing post screw, slide the screw head into the slot on the top of the back of the external unit. Loosely tighten post to screw to allow free moment

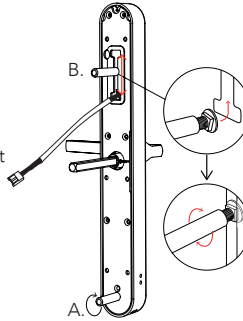

3. HANDING (AS REQUIRED)

Insert screwdriver into the spindle hole, remove screw to loosen the lever. Rotate the lever 180° and tighten the screw to reattach the lever. Repeat for the internal unit.

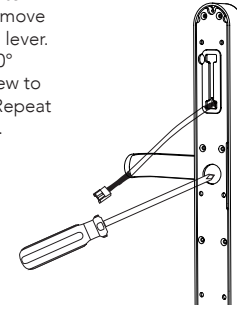

4. ADJUST SPINDLE HOLDER DIRECTION

Ensure the spindle holder arrow points in the direction of the lever.

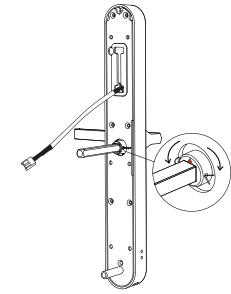

6. ATTACH GASKETS

Attach and secure rubber gaskets to the internal and external units.

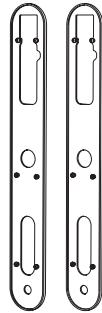

7. POSITION EXTERNAL UNIT TO THE DOOR

Position the external unit to sit flush on the door, ensuring the cable and spindle go through the fixing holes. Adjust the top fixing post to align with the top fixing hole.

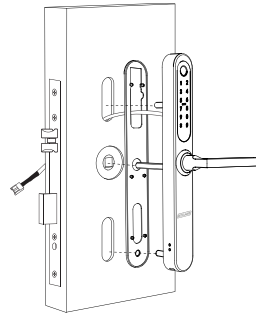

8. POSITION INTERNAL UNIT TO THE DOOR

Remove battery cover from internal unit.

Connect cables ensuring excess cable is concealed inside the door.

Line up spindle to the spindle hole in the body of the unit.

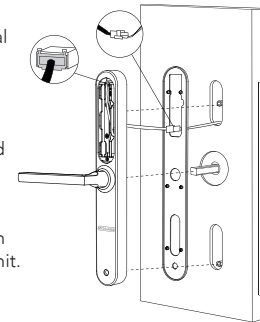

9. AFFIX UNIT TO DOOR

Affix the internal unit using the fixing screws.

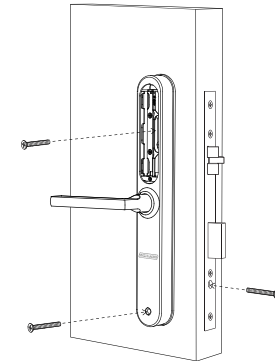

10. INSTALL BATTERIES

Install 4x AA alkaline batteries.

Secure the battery cover with screw

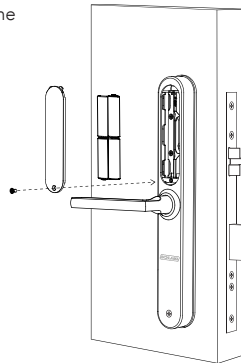

11. TEST LATCH OPERATION

A. Rotate the external lever, ensure latch bolt does not retract (refer to step 4).

B. Rotate the internal lever, ensure latch bolt does retract.

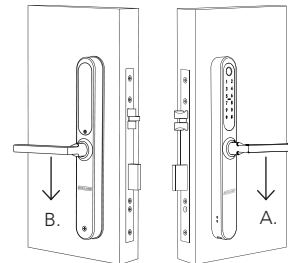

12. TEST BOLTS OPERATIONS

A. Rotate internal or external levers upwards to extend deadbolt.

B. Rotate internal lever downwards to retract deadbolt.

* Steps A and B only apply if deadbolt has been installed, refer to motise lock installation instructions.

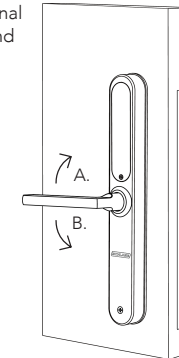

Scan the appropriate QR code opposite to download the Schlage Base app to your mobile device.

To pair the lock with the app, please refer to the user manual and app user manual for detailed pairing instructions. Both manuals can be accessed on schlage-locks.asia.



App Store download for iOS users



Google Play Store download for Android users