



Schlage **S-610DB** INSTALLATION MANUAL

1. PREPARE THE DOOR

Prepare the door as per the Schlage S-610DB Digital Door Lock Template.

Mount lock body into positions.

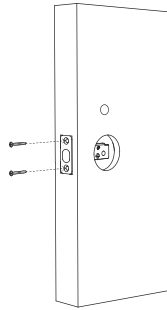

2. FASTEN POSTS

Attach the posts to the stud on the back of the external unit.

Ensure that the spindle is always kept horizontally.

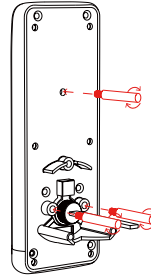

3. HANDING (AS REQUIRED)

Switch to L for left opening and R for right opening in the Printed Circuit Board of the internal panel.

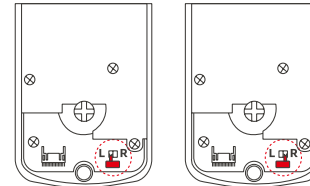

3. HANDING (CONTINUED)

Turn deadbolt knob horizontally for left opening and turn deadbolt vertically for right opening.

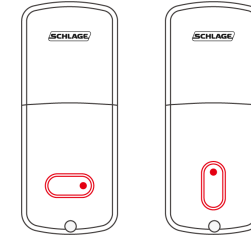

4. ATTACH GASKETS

Attach and secure a gasket to the external unit.

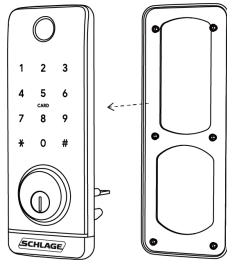

5. POSITION EXTERNAL UNIT TO THE DOOR

Position the external unit to sit flush on the door, ensuring that the cable and spindle go through the fixing holes.

Ensure the spindle is always in a horizontal position and the deadbolt is always retracted.

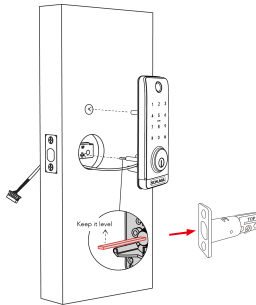

6. ATTACH GASKET AND SECURE FIXING PLATE

Attach and secure another gasket to the fixing plate of the external unit.

Screw and secure fixing plate to the door.

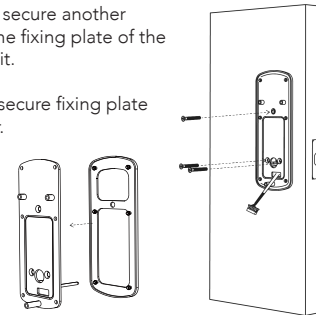

7. POSITION EXTERNAL UNIT TO THE DOOR

Remove battery cover. Connect the cable while ensuring excess cable is concealed inside the door.

Line up spindle and insert into the spindle hole located at the body of the unit.

Affix the internal unit using the fixing screws.

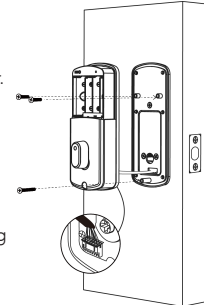

8. INSTALL BATTERIES

Install 4x AA alkaline batteries and secure the battery cover.

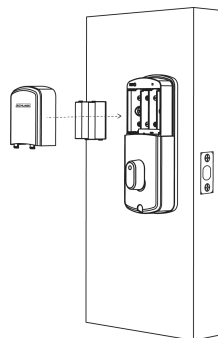

Scan the appropriate QR code opposite to download the Schlage Base app to your mobile device.

To pair the lock with the app, please refer to the user manual and app user manual for detailed pairing instructions. Both manuals can be accessed on schlage-locks.asia.



App Store download for iOS users



Google Play Store download for Android users